

PROPOSED G+8th STORIED RESIDENTIAL BUILDING
 WITH DE-ELEVATED THREE LAYER PARKING U/S. 393A, OF K.M.C. ACT.1980 ,
 (HT.- 29.150 M.), AT PREMISES NO.-338, BRIJI ROAD,
 R.S. PLOT NO.-13, R.S. KHATIAN NO.-106,OF MOUZA-CHAKGARIA,
 J.L. NO.-26, WARD NO-110, BOROUGH-XI,P.S.-PATULI KOLKATA-700094,UNDER K.M.C.

Anirban Bakshi

ANIRBAN BAKSHI
 Architect
 Council of Architecture
 CA / 2001 / 27297

SITE COORDINATES:

88 23 31.89-22 28 38.53, 88 23 32.374-22 28 39.080,
 88 23 32.923-22 28 38.034, 88 23 33.241-22 28 38.357,

Latitude - 88 23 31.89

Longitude - 22 28 38.53

SIGNATURE OF ARCHITECT

EXISTING
 G+IV STORIED
 327, BRIJI ROAD

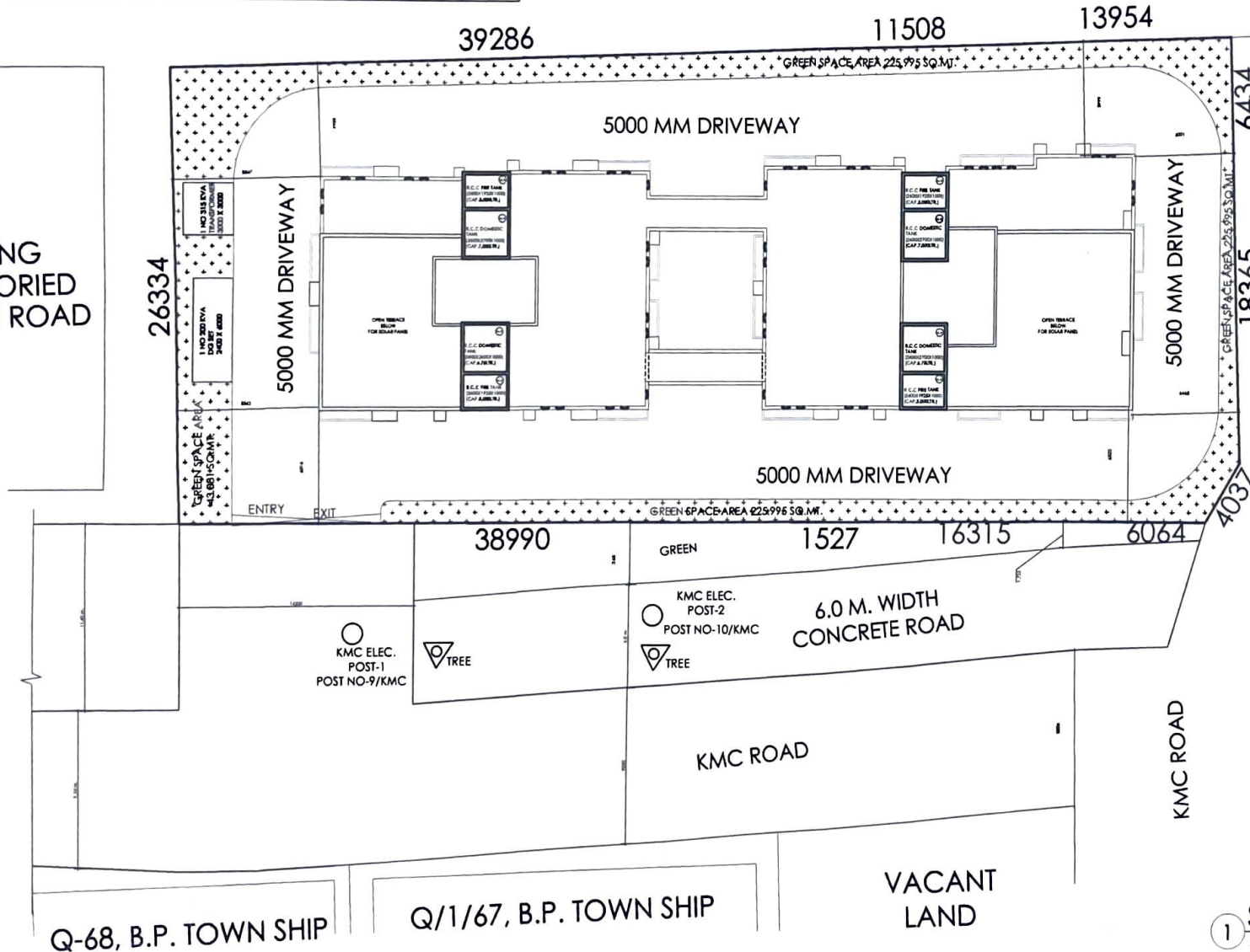

1 SITE PLAN
 SCALE - 1:250